

Colenta[®] MEDIPHOT 900 E

Automatic X-Ray Film Processor

For all standard X-Ray Films.

Certified for **Mammography - Film processing.**

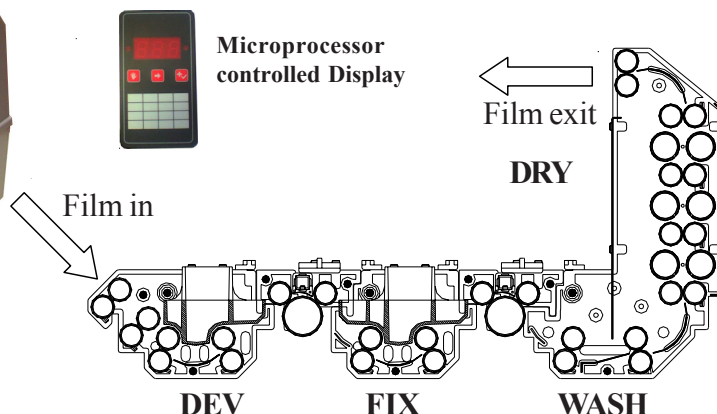

with **LVTT** (Low Volume Thin Tank) rack design, chemistry fully protected against air oxydation.

with **Intermediate Wash** between developer and fixer rack for reduced maintenance (cleaning requirements by the user), for reduced carryover of developer/contamination of fixer and reduced fixer replenishment.

with **Programmable Microprocessor Controller** incl. **Sensorbar** (6 pulsed IR-sensors) for exact **Detection of Film Area** for precise replenishment of chemistry, to control **Anti-oxidation/Standby-Replenishment Cycles, Anti-Crystallisation Cycles, Standby Mode, Processing Time/Speed** and **Dryer/Developer Temperature** of the processor.

with **Inline Heatexchanger** for developer/fixer heating with overheat protection and cold water cooling facility ($\pm 0,2^{\circ}\text{C}$ for dev.).

with **Warm Air Dryer** with overheat protection.

with maintenance free, **Inline Gear Drive System** (no worm gear drive used!).

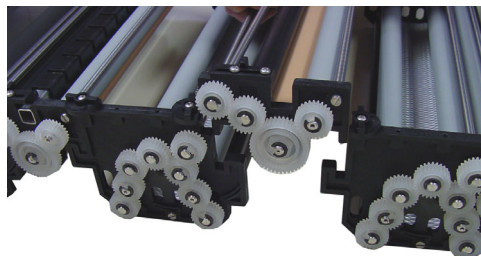

Skip over segments for easy access for cleaning.

Technical Specifications:

max. Film width:	36cm/14inch
min. Film lenght:	10cm/4inch
Tankbody PA:	Dev/Fixer/Wash 2,3 lt. each
Dev. Temp. Range:	18-43°C $\pm 0,2^{\circ}\text{C}$
Dryer Temperature:	approx 50°C
Replenishment:	variable / programmable 0-800ml/m ²

Capacity at cycle time (Dry to Dry):	intake speed (cm/min)	dev time (sec)
90 sec	69	17
110 sec	57	21
150 sec	42	29
180 sec	35	35

Electr. Power Supply:	230V, 50/60 Hz, 1,7kW
Water Supply:	R3/4", max 18°C, 3-6 bar
	1,5 - 2 lt./min
Water Drain:	32mm (5/4inch) hose or tube

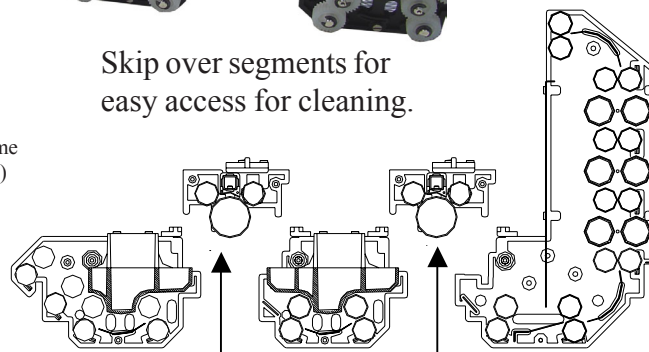

Intermediate Rinse Cross over rollers



Technical specification subject to change without notice.

see additional:
Technical
Data sheet

COLENTA LABORTECHNIK
Ges.m.b.H. & Co. KG
Neunkirchner Strasse 117
A-2700 Wiener Neustadt
Tel.: +43-2622-28311-0
Fax: +43-2622-28311-7
E-mail: office@colenta.at

ACI-COLENTA
INTERNATIONAL Div.
Forge Close, Little End Rd,
Eaton Socon, Cams. UK
Tel. +44-1480-211118
Fax: +44-1480-215236
E-mail: aci@patflaherty.com